

### ELECTRICAL SPECIFICATION

1. ANTENNA TYPE	: Dipole Antenna Swivel Type	6. ADMITTED POWER RADIATION:	5W
2. FREQUENCY RANGE	: 2.4GHz	7. TYPE OF RADIATION	: Omni
3. IMPEDANCE	: 50 Ohms	8. POLARIZATION	: Vertical
4. GAIN	: < 5 dBi	9. ELECTRICAL LENGTH	: 5/8 λ Dipole
5. VSWR	: ≤ 2.0	10. STANDARD CONNECTOR	: SMA (Male)

### Pattern

(1) Polar	: E-plan
Freq.(MHz)	: 2450
Peak Gain (dBi)	: 4.34
Peak angle	: 10.00
Avg. Gain(dBi)	: -1.68

(2) Polar	: H-plan
Freq.(MHz)	: 2450
Peak Gain (dBi)	: 4.67
Peak angle	: 1.00
Avg. Gain(dBi)	: 3.51

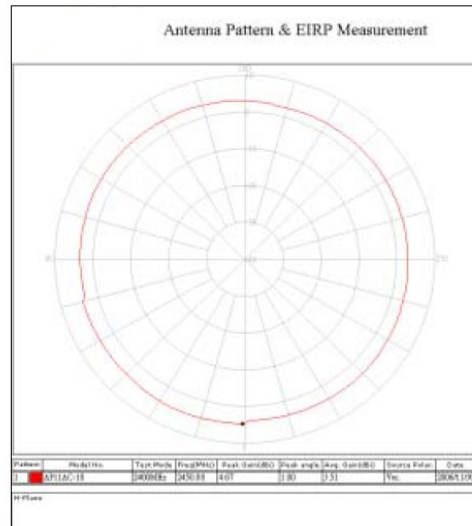
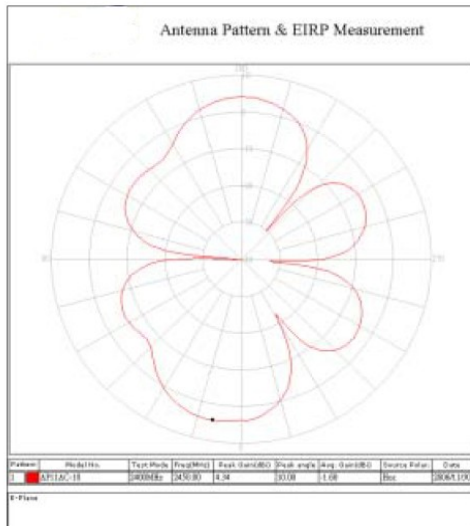

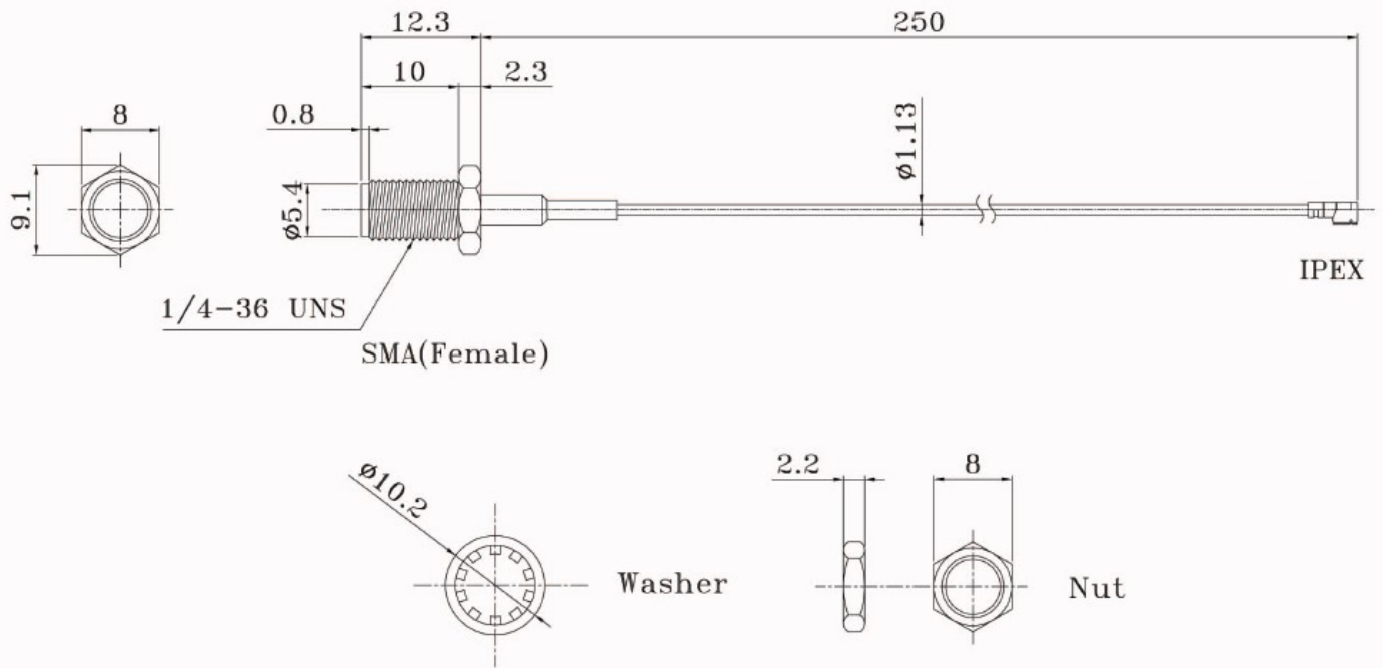

## MECHANICAL SPECIFICATION

1. IMPEDANCE : 50 Ohms
2. CONNECTOR : SMA (Female)  
I-PEX
3. CABLE : Coaxial ( $\phi$  1.13)
4. TOTAL LENGTH : 250±2mm
5. MECHANISM

	Description	Material	Treatment
①	Connector (SMA)	Brass	Golden
②	Coaxial Cable	—	—
③	Connector (I-PEX)	Brass	Golden

