



产品规格书

MOTOR MODEL(摩打型号):F-10-19196-8(CN13189-1)强磁 DV

Print Date:09/14/2023

MOTOR OUTLINES(摩打结构图):

MOTOR PHOTO:

DIRECTION OF ROTATION

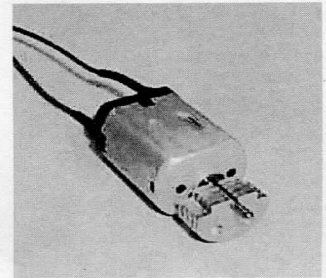
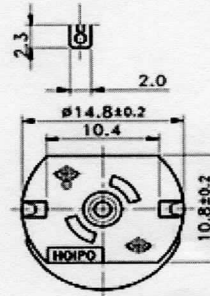
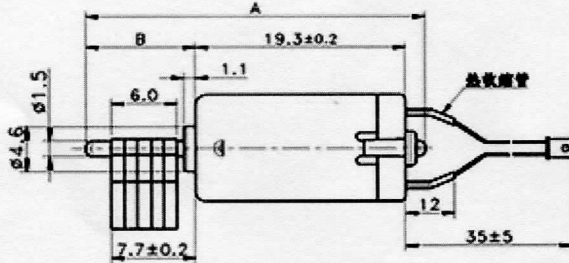
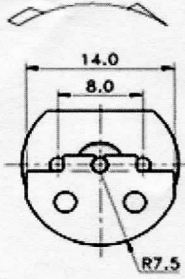

WEIGHT:12g(APPROX)

UNIT:mm

LENGTH OF PRODUCT(产品总长)(A): 31.0mm (±0.1)	FRONT EXTENSION(前端)(B): 10.0mm (±0.5)
---	---------------------------------------

MOTOR TECHNICAL DATA(摩打技术数据): Remark:Data mark with\*are average value(备注:带有\*号的数据为平均数值)

MODEL 型号	VOLTAGE(电压)		RATED LOAD(额定负载)		STALL (堵转)		
	OPERATING RANGE 操作范围	NOMINAL 额定电压	SPEED 转速 rpm	CURRENT 电流 A	TORQUE 扭力 mN.m / g.cm		CURRENT 电流 A
F-10-19196-8	1.5-3.0V	3.0V	* 5600	* 0.35	/	/	* 0.65
GENERAL TEST TOLERANCE 正常测试公差			±15%	0.46MAX 最大值	/	/	0.78MAX 最大值

Standard Testing Condition(标准测试条件):

Temperature 20±5°C,relative humidity 65±15% | Parameters should be measured after motor has been running for 20 seconds

温度20±5°C, 相对湿度65±15% | 马达参数必需于马达运作20秒后方可进行测试

备注: 额定负载为带偏心铰R7.5\*6.0mm(1.2\*5片)

PRODUCE BY(制作人):	INSPECT BY(审核人):	CONFIRM BY(确认人):
------------------	------------------	------------------