

<b>cell type:</b>	Li-Ion	
<b>cell size:</b>	18650	
<b>built-in cell:</b>	Samsung ICR 18650-26J / ICR 18650-26JM (3.63V / 2600mAh)	
<b>Conditions</b>		
<b>nominal voltage:</b>	3.6 V	
<b>capacity</b>		
nominal:	2600 mAh	discharge at 0.2C
minimum:	2500 mAh	discharge at 0.2C
	2400 mAh	discharge at 1C
	ta: 20°C; EV(Discharge End Voltage): 2.75V	
<b>discharge</b>		
max. continuous discharge current:	5000 mA	ta: 0...45°C
	<b>important:</b> avoid cell temperature above 60°C	
discharge end voltage:	≥ 2.75 V	(recommended)
<b>external charge (at +/- poles)</b>		
charging method:	CC - CV (Constant Current - Constant Voltage)	
charge current:	520 mA	at standard charge
max. charge current:	2600 mA	at fast charge
charge end voltage:	4.2 V	± 50mV
charge cut off		
by time:	5...6 h	at standard charge
	1.5...2.0 h	at fast charge
by current drop:	50 mA	end current - cut off
<b>charge via micro USB connector (with USB charger)</b>		
supply voltage:	5 V	± 0.25V
charge current:	≤ 1150 mA	
charge time:	≤ 3 h	at 1A charge
<b>internal resistance:</b>	≤ 100 mΩ	at 1kHz, sine wave measurement according to IEC 896-2
energy:	9.36 Wh	
<b>protection functions</b>		
overcharge cut off voltage:	4.3 V	± 0.05V
deep disch.cut off voltage:	2.5 V	± 0.1V
overload cut off current:	12 A	max.
<b>LED charge indicator (w. micro USB charge)</b>	lights red	during charge
	lights green	end of charge; battery fully charged
<b>life time expectance (C&gt;70% of min. capacity)</b>	≥ 300 cycles	at 0.5C charge/discharge rate
<b>self discharge:</b>	≤ 2 %/month	at 20°C
	≤ 5 %/month	at 30°C
	≤ 10 %/month	at 40°C
<b>ambient temperature range:</b>	0...45 °C	charge
	- 20...60 °C	discharge
	- 20...25 °C	storage max. 1year
	- 20...45 °C	storage max. 3months
recommended SOC: (SOC = state of charge)	30...50 %	for long-time stoarge
<b>mechanical specifications</b>		
cell dimensions (incl. sleeve)		
diameter d1:	18.5 ± 0.3	mm
diameter d2:	5 ± 0.15	mm
height h1:	70.0 - 2	mm
height h2:	0.5 + 0.3	mm
weight:	47.5 ± 3	g

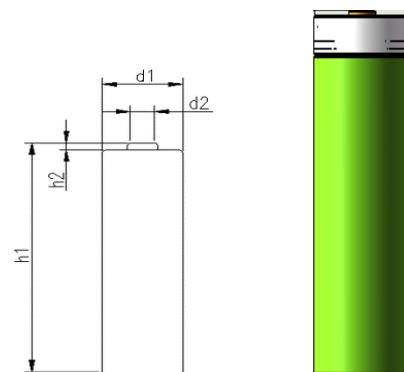
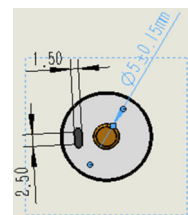

	<b>ANSMANN Specifications for model:</b>	<b>Protected 18650 Li-Ion Battery 3.6V 2600mAh w. Micro USB Charge</b>
	data sheet no. / part no.	
	supplier no.	704507
	author / date	TG / 04.11.2019