

## INSTALLATION INSTRUCTION SPOTLIGHT FITTING

### TECHNICAL DATA

Model	VT-882SQ	VT-882RD
Shape	Square	Round
Base	GU10	GU10
IP Rating	IP20	IP20
Dimension	74x74x140mm	Ø80x140mm



### INTRODUCTION

Thank you for selecting and buying V-TAC product. V-TAC will serve you the best. Please read these instructions carefully before starting the installing and keep this manual handy for future reference. If you have any another query, please contact our dealer or local vendor from whom you have purchased the product. They are trained and ready to serve you at the best.

### WARNING!

1. Please make sure to turn off the power before starting the installation.
2. Installation should only be done by a certified electrician.



This marking indicates that this product should not be disposed of with other household wastes.

### INSTALLATION INSTRUCTION

- Switch off the power.
- Drill the appropriate hole on the ceiling, then put the plastic wall plug into the hole (Pic 2 and 3).
- Install GU10 lamp into the holder & the fitting (Pic 4).
- Connect to the AC wires & install the fitting into the bracket (Pic 5 and 6).
- Switch on the power if above steps done properly without any mistakes (Pic 7)

### INSTALLATION DIAGRAM:

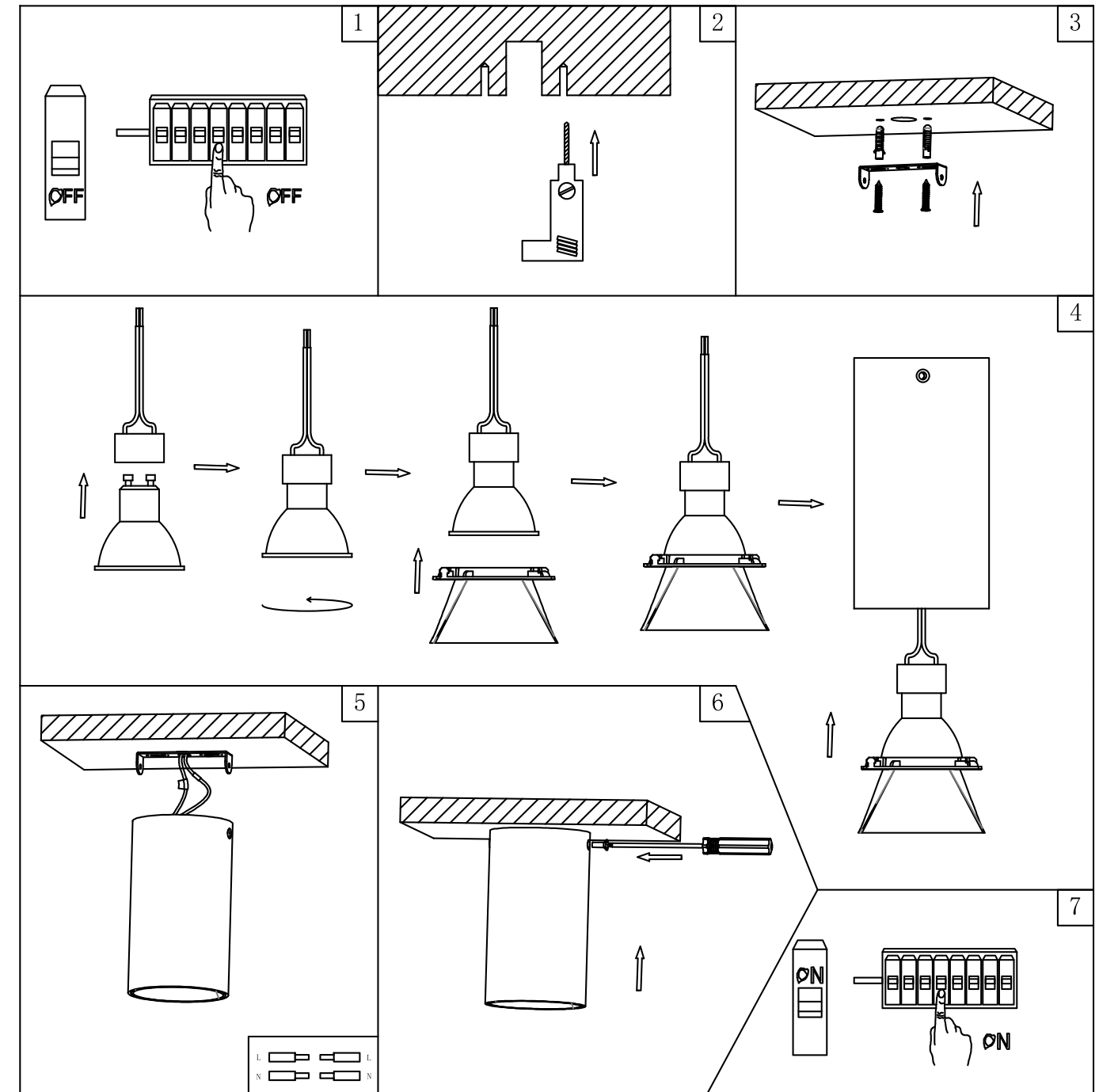

**IN CASE OF ANY QUERY/ISSUE WITH THE PRODUCT, PLEASE REACH OUT TO US AT: [SUPPORT@V-TAC.EU](mailto:SUPPORT@V-TAC.EU)  
 FOR MORE PRODUCTS RANGE, INQUIRY PLEASE CONTACT OUR DISTRIBUTOR OR NEAREST  
 DEALERS. V-TAC EUROPE LTD. BULGARIA, PLOVDIV 4000, BUL.L.KARAVELOW 9B**