

M12-Receptacle Connectors In Accordance With IEC 61076-2-101

RSFM/0.5 M | RKFM/0.5 M



Male, 3-, 4-, 5- and 8-Pole

Receptacle connector, combined FIXCON/M12 male connector for front mounting, assembled stranded wire, solder contacts potted with epoxy, chassis side thread M16 x 1.5 (panel nut RSKFM 16).

RSFM/0.5 M

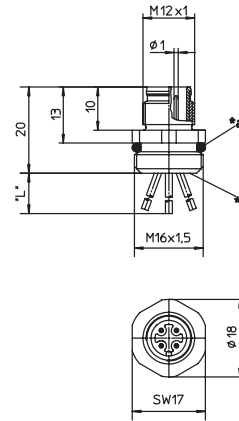

*a O-ring enclosed separately

*b solder contacts potted with epoxy

L 0,5 m



Female, 3-, 4-, 5- and 8-Pole

Receptacle connector, combined FIXCON/M12 female connector for front mounting, assembled stranded wire, solder contacts potted with epoxy, chassis side thread M16 x 1.5 (panel nut RSKFM 16).

RKFM/0.5 M

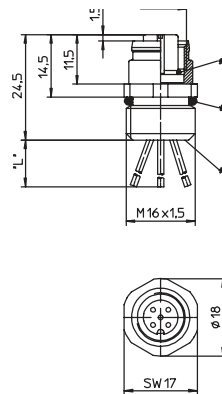

*a O-Ring

*b O-ring enclosed separately

*c solder contacts potted with epoxy

Pin Assignments

Face Views / M12, Male / Female

3 pole

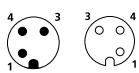

1 = brown
3 = blue
4 = black

4 pole

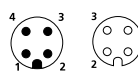

1 = brown
2 = white
3 = blue
4 = black

5 pole

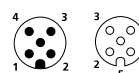

1 = brown
2 = white
3 = blue
4 = black
5 = green/yellow

8 pole

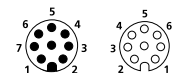

1 = white
2 = brown
3 = green
4 = yellow
5 = grey
6 = pink
7 = blue
8 = red



Be Certain with Belden

M12-Receptacle Connectors In Accordance With IEC 61076-2-101
 RSFM/0.5 M | RKFM/0.5 M

Technical Data

Environmental







Degree of protection IP 67 / NEMA 6P
 Operating temperature range -25°C (-13°F) / +80°C (+176°F)

Mechanical

Housing / Molded body CuZn, nickel-plated
 Insert PA
 8 poles TPU
 Contact CuZn, pre-nickel and 0.8 microns gold-plated
 O-ring FKM

Electrical

Contact resistance ≤ 5 mΩ
 Nominal current at 40°C 3-5 poles 4 A
 8 poles 1,5 A
 Nominal voltage 3-4 poles 240 V
 5 poles 60 V
 poles 30 V
 Rated voltage 3-4 poles 250 V
 5 poles 63 V
 8 poles 36 V
 Test voltage 3-4 poles 2.0 kV eff. / 60 s
 5-8 poles 1.5 kV eff. / 60 s
 Insulation resistance > 10⁹ Ω
 Pollution degree 3

Part Number	Pins	Leads (mm ²)	Characteristics
RSFM 3/0.5 M RKFM 4-3/0.5 M	3	0.34	 
RSFM 4/0.5 M RKFM 4/0.5 M	4	0.34	 
RSFM 5/0.5 M RKFM 5/0.5 M	5	4 x 0.34 / 1 x 0.50	 
RSFM 8/0.5 M RKFM 8/0.5 M	8	0.25	