

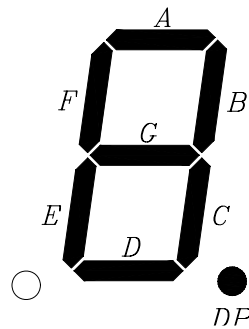

Package Dimensions

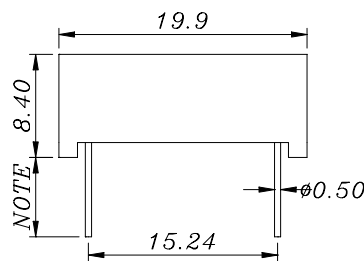
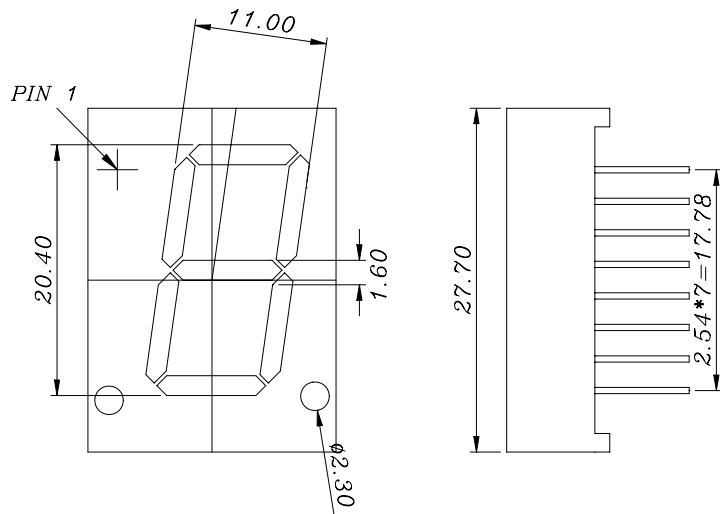

| | | | |
|------|------|-----|------|
| NOTE | S | E | T |
| | 3.86 | 4.4 | 6.38 |

3,5,11,16

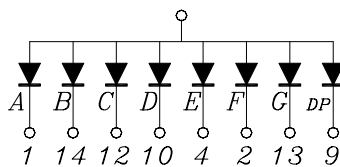

7,8,15 NO PIN
6 NO CONNECT

- | | |
|----------------|-----------------|
| 1 CATHODE A | 9 CATHODE RDP |
| 2 CATHODE F | 10 CATHODE D |
| 3 COMMON ANODE | 11 COMMON ANODE |
| 4 CATHODE E | 12 CATHODE C |
| 5 COMMON ANODE | 13 CATHODE G |
| 6 NO CONNECT | 14 CATHODE B |
| 7 NO PIN | 15 NO PIN |
| 8 NO PIN | 16 COMMON ANODE |

Notes:

- All dimensions are in millimeters (inches).
- Tolerance is $\pm 0.30\text{mm}(.010\text{'})$ unless otherwise noted.
- Protruded resin under flange is 1.0mm(.04'') max.
- Lead spacing is measured where the leads emerge from the package.
- Specifications are subject to change without notice.



Electrical / Optical Characteristics at TA=25°C

| Parameter | Symbol | Min. | Typ. | Max. | Unit | Test Condition |
|---------------------------------------|------------------|------|------|------|---------|----------------|
| Average Luminous Intensity | IV | 7 | 9 | | mcd | IF = 20mA |
| Peak Emission Wavelength | λP | | 639 | | nm | IF = 20mA |
| Dominant Wavelength | λd | 620 | 631 | 636 | nm | IF = 20mA |
| Spectral Line Half-Width | $\Delta \lambda$ | | 20 | | nm | IF = 20mA |
| Forward Voltage, any Segment or D..P. | VF | | 2.1 | 2.6 | V | IF = 20mA |
| Reverse Current, any Segment or D..P | IR | | | 100 | μA | VR = 5V |
| Luminous Intensity Matching Ratio | Iv-m | | | 2:1 | | IF = 20mA |

Absolute Maximum Ratings at TA=25°C

| Parameter | Maximum Rating | Unit |
|--|---------------------|------|
| Power Dissipation | 45 | mW |
| Peak Forward Current (1/10 Duty Cycle, 0.1ms Pulse Width) | 100 | mA |
| Continuous Forward Current | 25 | mA |
| Reverse Voltage | 5 | V |
| Operating Temperature Range | -20°C to + 80°C | |
| Storage Temperature Range | -55°C to + 100°C | |
| Lead Soldering Temperature [1.6mm(.063") From Body] | 260°C for 5 Seconds | |

TYPICAL ELECTRON-OPTICAL CHARACTERISTIC CURVES
25°C Free Air Temperature Unless Otherwise Specified

