

PSP TYPE

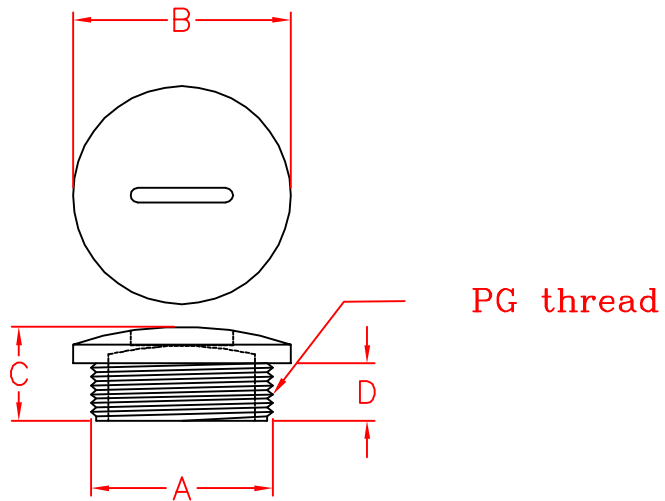

ITEM NO.	External thread	A	B	C	D
PSP-7	Pg-7	12.2±0.35	14.8±0.35	10.0±0.35	6.0±0.25
PSP-9	Pg-9	15.1±0.35	18.7±0.35	10.4±0.35	6.0±0.25
PSP-11	Pg-11	18.5±0.35	21.7±0.5	10.4±0.35	6.0±0.25
PSP-13.5	Pg-13.5	20.3±0.5	23.7±0.5	10.3±0.35	6.0±0.25
PSP-16	Pg-16	22.3±0.5	27.0±0.5	10.3±0.35	6.0±0.25
PSP-21	Pg-21	28.2±0.5	32.8±0.5	12.8±0.35	7.8±0.25
PSP-29	Pg-29	37.0±0.5	44.1±1.0	13.2±0.35	7.8±0.25
PSP-36	Pg-36	47.0±1.0	52.6±1.0	13.7±0.35	7.8±0.25
PSP-42	Pg-42	54.0±1.0	59.5±1.0	16.2±0.35	9.6±0.25
PSP-48	Pg-48	59.6±1.0	64.2±2.0	17.5±0.35	11.8±0.35

承認
KSS
108.08.27
邱平裕

審查

製圖
KSS
108.08.27
吳經立

設計

中文名		MATERIAL	UL 94V-2	ITEM NO.	PSP TYPE	
旋車專式塞頭			NYLON 66			
SCALE		FINISH		NAME	SCREW PLUG	
mm						
△	(°)	TOLERANCE		△	08-27-2019	REVISIONS K001
AS FIGURE				DATE		R.NO.

